

SITE NOTICE

**NOTICE OF MAKING OF A PUBLIC PATH DIVERSION ORDER AND  
DEFINITIVE MAP AND STATEMENT MODIFICATION ORDER**

**HIGHWAYS ACT 1980  
WILDLIFE AND COUNTRYSIDE ACT 1981**

**THE NORTH YORKSHIRE COUNCIL**

**PUBLIC FOOTPATHS NOS 10.164/1 & 10.164/2, WRAY HOUSE, WELBURY  
DIVERSION ORDER 2025**

The above Order, made on 04/03/2025, under Section 119 of the Highways Act 1980 and Section 53A(2) of the Wildlife and Countryside Act 1981, will divert the Public Footpaths described below.

Public Footpath 10.164/1 between SE 3927 9965 and SE 3939 9969, via SE 3931 9967 will be diverted onto a new route between SE 3927 9965 and SE 3939 9969 via SE 3929 9964 and SE 3931 9962. Public Footpath 10.164/2 between SE 3937 9973 and SE 3931 9967 will be diverted onto a new route from SE 3937 9973 to SE 3939 9969.

A copy of the Order and the Order map have been placed and may be seen free of charge during normal office hours at Northallerton Library, North Yorkshire until 11/04/2025. Copies of the Order and map may be purchased from Countryside Access Services, North Yorkshire Council, County Hall, Northallerton, North Yorkshire, DL7 8AD (tel: 03001312131) at a cost of £2 or can be downloaded free from our website [www.northyorks.gov.uk/pathnotices](http://www.northyorks.gov.uk/pathnotices).

Any representations about or objections to the Order may be sent in writing to Steve Metcalfe, Definitive Map Team, North Yorkshire Council, County Hall, Northallerton, North Yorkshire DL7 8AD or email [steve.metcalfe@northyorks.gov.uk](mailto:steve.metcalfe@northyorks.gov.uk) not later than 11/04/2025. Please state the grounds on which they are made.

Please note that objections/representations cannot be treated as confidential and may come into the public domain. Copies of any objections or representations received may be disclosed to interested parties, including the Planning Inspectorate where the case is referred to it for determination.

If no such representations or objections are duly made, or if any so made are withdrawn, The North Yorkshire Council may confirm the Order as an unopposed Order. If the Order is sent to the Secretary of State for the Environment for confirmation, any representations and objections which have not been withdrawn will be sent with the Order.

Dated 14/03/2025

Barry Khan  
Assistant Chief Executive  
(Legal and Democratic Services)  
County Hall  
Northallerton  
North Yorkshire  
DL7 8AH



**PUBLIC PATH DIVERSION AND  
DEFINITIVE MAP AND STATEMENT MODIFICATION ORDER**

**HIGHWAYS ACT 1980**

**WILDLIFE AND COUNTRYSIDE ACT 1981**

**THE NORTH YORKSHIRE COUNCIL**

**PUBLIC FOOTPATHS NOS 10.164/1 & 10.164/2, WRAY HOUSE,  
WELBURY DIVERSION ORDER 2025**

Barry Khan  
Assistant Chief Executive  
(Legal and Democratic Services)  
County Hall  
Northallerton  
DL7 8AH

**PUBLIC PATH DIVERSION AND  
DEFINITIVE MAP AND STATEMENT MODIFICATION ORDER**

**HIGHWAYS ACT 1980**

**WILDLIFE AND COUNTRYSIDE ACT 1981**

**THE NORTH YORKSHIRE COUNCIL**

**PUBLIC FOOTPATHS NOS 10.164/1 & 10.164/2, WRAY HOUSE, WELBURY DIVERSION  
ORDER 2025**

This Order is made by The North Yorkshire Council ("the Authority") under Section 119 of the Highways Act 1980 ("the 1980 Act") because it appears to the Authority that in the interests of the public it is expedient that the line of the Public Footpaths should be diverted.

This Order is also made under Section 53A(2) of the Wildlife and Countryside Act 1981 ("the 1981 Act") because it appears to the Authority that The District of Hambleton (outside The North York Moors National Park) Definitive Map and Statement require modification in consequence of the occurrence of an event specified in Section 53(3)(a)(i) of the 1981 Act, namely, the diversion (as authorised by this Order) of a highway shown or required to be shown in the map and statement.

Welbury Parish Council have been consulted as required by Section 120(2) of the 1980 Act.

**BY THIS ORDER:**

1. The public rights of way over the land situated at Wray House, Welbury and shown by a bold continuous line on the map contained in this Order and described in Part 1 of the Schedule to this Order shall be stopped up on the date on which the Authority certifies, in accordance with Section 119(3)(b) of the 1980 Act, that work to the new sections of path, as described in Part 2 of the Schedule, has been completed to the reasonable satisfaction of the Authority. Under no circumstances shall such certification be given before the date of confirmation of this Order.
2. There shall from the date of the above mentioned certification be Public Footpaths over the land situated at Wray House, Welbury described in Part 2 of the Schedule to this Order and shown by a bold broken line on the map contained in this Order.
3. The following works shall be carried out by the applicant in relation to the highway described in Part 2 of the Schedule: Pedestrian gates to BS5709:2018 to be installed at Points E and F on the attached plan.
4. The rights conferred on the public under this Order shall be subject to the limitations and conditions set out in Part 3 of the Schedule.
5. The District of Hambleton (outside The North York Moors National Park) Definitive Statement shall be modified as described in Part 4 of the Schedule to this Order.

THE COMMON SEAL of THE NORTH  
YORKSHIRE COUNCIL

was hereunto affixed this <sup>4<sup>th</sup></sup> day  
of MARCH 2025,  
in the presence of:-

*Catrina Cable*



SCHEDULE

PART 1

DESCRIPTION OF SITE OF EXISTING PUBLIC FOOTPATHS

<u>Section of Public Footpath to be extinguished as shown on the attached map</u>	<u>Position</u>	<u>Width</u>
Public Footpath 10.164/1 as marked with a bold continuous line (A-B-C) on the attached plan.	From Grid Reference 43927 49965 (Point A) proceeds in a generally north east direction through the farmyard of Wray House for approximately 46 metres to Grid Reference 43931 49967 (Point B) and then proceeds in an east north east direction for approximately 84 metres to Grid Reference 43939 49969 (Point C).	Not Recorded
<u>Section of Public Footpath to be extinguished as shown on the attached map</u>	<u>Position</u>	<u>Width</u>
Public Footpath 10.164/2 as marked with a bold continuous line (B-D) on the attached plan	From Grid Reference 43931 49967 (Point B) proceeds in a north east direction for approximately 86 metres to Grid Reference 43937 49973 (Point D).	Not Recorded

PART 2

DESCRIPTION OF SITE OF NEW PUBLIC FOOTPATHS

<u>Section of Public Footpath to be created as shown on the attached map</u>	<u>Position</u>	<u>Width</u>
Public Footpath 10.164/1 as marked with a bold dashed line (A-E-F-C) on the attached map.	From Grid Reference 43927 49965 (Point A) proceeds in a generally south east direction for approximately 15 metres to a pedestrian gate at Grid Reference 43929 49964 (Point E) and then continues in a generally south east direction for approximately 26 metres to a pedestrian gate at Grid Reference 43931 49962 (Point F) and then proceeds in a north east direction for approximately 109 metres to Grid Reference 43939 49969 (Point C).	2 metres
<u>Section of Public Footpath to be created as shown on the attached map</u>	<u>Position</u>	<u>Width</u>
Public Footpath 10.164/2 as marked with a bold dashed line (C-D) on the attached map.	From Grid Reference 43939 49969 (Point C), proceeds in a north north west direction for approximately 47 metres to Grid Reference 43937 49973 (Point D).	2 metres

PART 3

LIMITATIONS AND CONDITIONS

<u>Position on Public Footpath 10.164/1 to which limitations and conditions apply</u>	<u>Limitations and Conditions</u>
Grid Reference 43929 49964 (Point E)	Pedestrian Gate to BS5709:2018
Grid Reference 43931 49962 (Point F)	Pedestrian Gate to BS5709:2018



PART 4

MODIFICATION OF DEFINITIVE STATEMENT  
VARIATION OF PARTICULARS OF PATH OR WAY

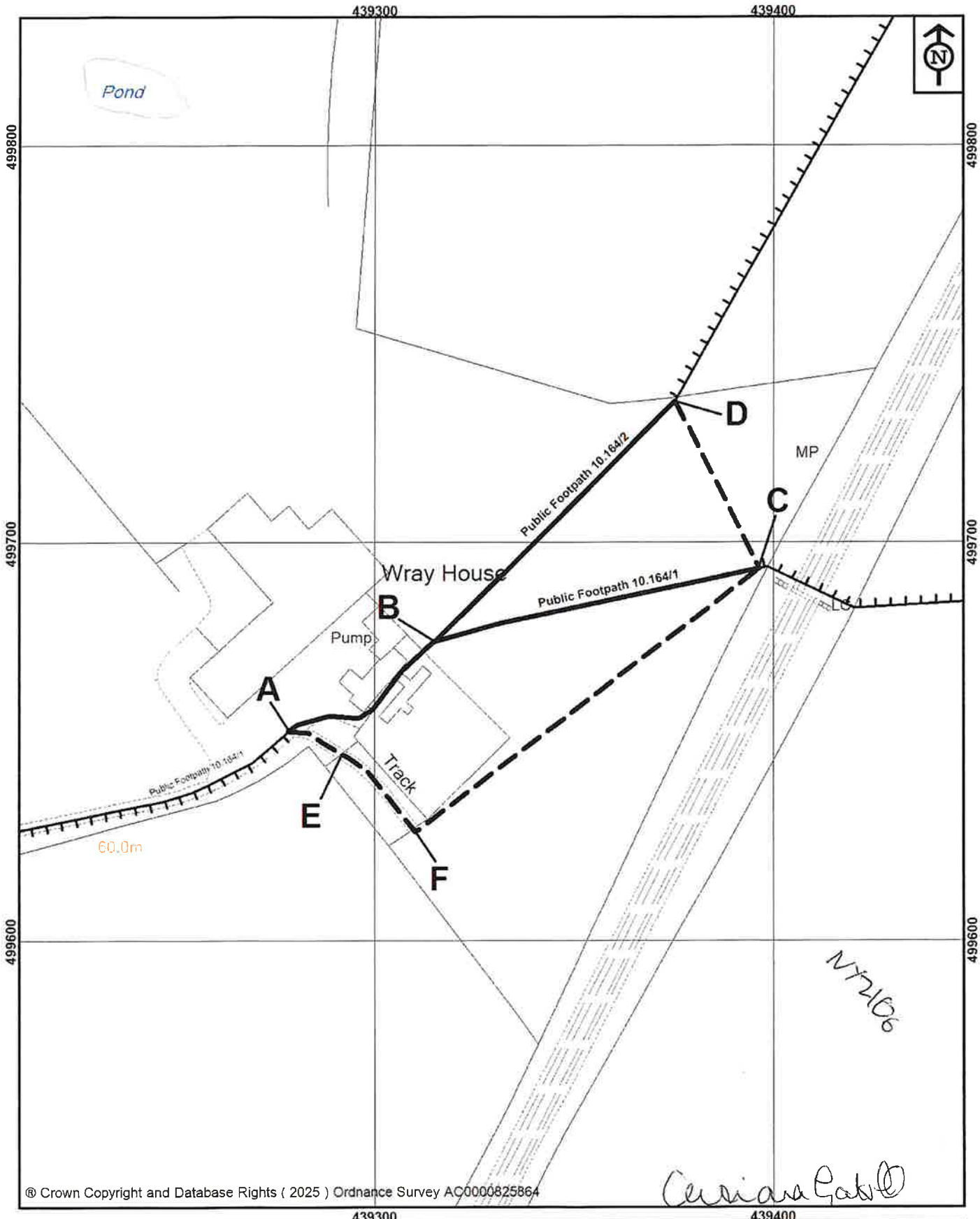
Path No.	Grid Reference End Points	Description	Nature of Surface	Length (Km)	Width (m)	Lawful Obstructions and Conditions
Public Footpath 10.164/1	Not Recorded.	Not Recorded	Not Recorded	Not Recorded	Not Recorded	Not Recorded
		<p><b>From Grid Reference 43927 49965 proceeds in a generally south east direction for approximately 15 metres to a pedestrian gate at Grid Reference 43929 49964 and then continues in a generally south east direction for approximately 26 metres to a pedestrian gate at Grid Reference 43931 49962 and then proceeds in a north east direction for approximately 109 metres to Grid Reference 43939 49969.</b></p>	Grass	0.15	2 metres	<p><b>Pedestrian Gate GR 43929 49964</b></p> <p><b>Pedestrian Gate GR 43931 49962</b></p>
Public Footpath 10.164/2	Not Recorded.	Not Recorded	Not Recorded	Total:Not Recorded	Not Recorded	Not Recorded
		<p><b>From Grid Reference 43939 49969, proceeds in a north north west direction for approximately 47 metres to Grid Reference 43937 49973.</b></p>	Grass	0.047	2 metres	
		Not Recorded	Not Recorded	Total: Not Recorded	Not Recorded	Not Recorded



**NORTH YORKSHIRE COUNCIL**  
 Public Rights of Way  
 Countryside Access Service  
 County Hall  
 Northallerton  
 DL7 8AH

**Key:**  
 Footpath to be added   
 Footpath to be deleted   
 Other footpaths   
 Map drawn on 26 February 2025  
 Drawn by SCM      Scale 1:1250

**The North Yorkshire Council**  
 Highways Act 1980 Section 119  
 Wildlife & Countryside Act 1981  
 Public Footpaths Nos 10.164/1 &  
 10.164/2, Wray House, Welbury  
 Diversion Order 2025  
 File Ref No. HAM/2022/24/DO