

SITE NOTICE

**NOTICE OF MAKING OF A PUBLIC PATH DIVERSION ORDER AND  
DEFINITIVE MAP AND STATEMENT MODIFICATION ORDER**

**HIGHWAYS ACT 1980  
WILDLIFE AND COUNTRYSIDE ACT 1981**

**THE NORTH YORKSHIRE COUNCIL**

**PUBLIC FOOTPATH 10.72/15, WHITE HOUSE FARM, HUTTON RUDBY  
DIVERSION ORDER 2025**

The above Order, made on 14/01/2025, under Section 119 of the Highways Act 1980 and Section 53A(2) of the Wildlife and Countryside Act 1981, will divert the Public Footpath described below.

Public Footpath 10.72/15 between NZ 4483 0300 and NZ 4506 0330 will be diverted onto a new route from NZ 4483 0300 to NZ 4509 0326 via NZ 4484 0300 and NZ 4496 0306. The new route will cross into Potto Parish and where it does so it will be redesignated as Public Footpath 10.118/18.

A copy of the Order and the Order map have been placed and may be seen free of charge during normal office hours at Stokesley Library, North Yorkshire until 28/02/2025. Copies of the Order and map may be purchased from Countryside Access Services, North Yorkshire Council, County Hall, Northallerton, North Yorkshire, DL7 8AD (tel: 03001312131) at a cost of £2 or can be downloaded free from our website <https://www.northyorks.gov.uk/pathnotices>.

Any representations about or objections to the Order may be sent in writing to Steve Metcalfe, Definitive Map Team, North Yorkshire Council, County Hall, Northallerton, North Yorkshire DL7 8AD or email [steve.metcalfe@northyorks.gov.uk](mailto:steve.metcalfe@northyorks.gov.uk) not later than 28/02/2025. Please state the grounds on which they are made.

Please note that objections/representations cannot be treated as confidential and may come into the public domain. Copies of any objections or representations received may be disclosed to interested parties, including the Planning Inspectorate where the case is referred to it for determination.

If no such representations or objections are duly made, or if any so made are withdrawn, The North Yorkshire Council may confirm the Order as an unopposed Order. If the Order is sent to the Secretary of State for the Environment for confirmation, any representations and objections which have not been withdrawn will be sent with the Order.

Dated 31/01/2025

Barry Khan  
Assistant Chief Executive  
(Legal and Democratic Services)  
County Hall  
Northallerton  
North Yorkshire  
DL7 8AH



**PUBLIC PATH DIVERSION AND  
DEFINITIVE MAP AND STATEMENT MODIFICATION ORDER**

**HIGHWAYS ACT 1980**

**WILDLIFE AND COUNTRYSIDE ACT 1981**

**THE NORTH YORKSHIRE COUNCIL**

**PUBLIC FOOTPATH 10.72/15, WHITE HOUSE FARM, HUTTON RUDBY  
DIVERSION ORDER 2025**

Barry Khan  
Assistant Chief Executive  
(Legal and Democratic Services)  
County Hall  
Northallerton  
DL7 8AH

**PUBLIC PATH DIVERSION AND  
DEFINITIVE MAP AND STATEMENT MODIFICATION ORDER**

**HIGHWAYS ACT 1980**

**WILDLIFE AND COUNTRYSIDE ACT 1981**

**THE NORTH YORKSHIRE COUNCIL**

**PUBLIC FOOTPATH 10.72/15, WHITE HOUSE FARM, HUTTON RUDBY DIVERSION ORDER  
2025**

This Order is made by The North Yorkshire Council ("the Authority") under Section 119 of the Highways Act 1980 ("the 1980 Act") because it appears to the Authority that in the interests of the owner(s) of the land crossed by the Public Footpath described in Paragraph 1 of this Order it is expedient that the line of the Public Footpath should be diverted.

This Order is also made under Section 53A(2) of the Wildlife and Countryside Act 1981 ("the 1981 Act") because it appears to the Authority that The District Of Hambleton (outside The North York Moors National Park) Definitive Map and Statement require modification in consequence of the occurrence of an event specified in Section 53(3)(a)(i) of the 1981 Act, namely, the diversion (as authorised by this Order) of a highway shown or required to be shown in the map and statement.

Hutton Rudby And Potto Parish Councils have been consulted as required by Section 120(2) of the 1980 Act.

**BY THIS ORDER:**

1. The public right of way over the land situated at White House Farm, Hutton Rudby And Potto and shown by a bold continuous line on the map contained in this Order and described in Part 1 of the Schedule to this Order shall be stopped up on the date on which the Authority certifies, in accordance with Section 119(3)(b) of the 1980 Act, that work to the new section of path, as described in Part 2 of the Schedule, has been completed to the reasonable satisfaction of the Authority. Under no circumstances shall such certification be given before the date of confirmation of this Order.
2. There shall from the date of the above mentioned certification be a Public Footpath over the land situated at White House Farm, Hutton Rudby And Potto described in Part 2 of the Schedule to this Order and shown by a bold broken line on the map contained in this Order.
3. The following works shall be carried out in relation to the highway described in Part 2 of the Schedule: Provision of suitable 2 metre wide field edge path and pedestrian gaps to BS5709:2018 at Point C, Point D and Point E on the attached plan.
4. The rights conferred on the public under this Order shall be subject to the limitations and conditions set out in Part 3 of the Schedule.
5. The District Of Hambleton (outside The North York Moors National Park) Definitive Statement shall be modified as described in Part 4 of the Schedule to this Order.

THE COMMON SEAL of THE NORTH  
YORKSHIRE COUNCIL

was hereunto affixed this 14<sup>th</sup> day  
of JANUARY 2025  
in the presence of:-



SCHEDULE

PART 1

DESCRIPTION OF SITE OF EXISTING PUBLIC FOOTPATH

<u>Section of Public Footpath to be extinguished as shown on the attached map</u>	<u>Position</u>	<u>Width</u>
Public Footpath 10.72/15 as marked with a bold continuous line (A-B) on the attached plan.	Starts at Grid Reference 44483 50300 (Point A) and proceeds in a generally north east direction, through the garden of White House Farm and along the farm access track for approximately 382 metres to Grid Reference 44506 50330 (Point B).	Not Recorded

PART 2

DESCRIPTION OF SITE OF NEW PUBLIC FOOTPATH

<u>Section of Public Footpath to be created as shown on the attached map</u>	<u>Position</u>	<u>Width</u>
Public Footpath 10.72/15 as marked with a bold dashed line (A-C) on the attached plan.	Starts at Grid Reference 44483 50300 (Point A) and proceeds in a south east direction for approximately 4 metres, to the Parish boundary at a pedestrian gap at Grid Reference 44484 50300 (Point C).	2 metres
Public Footpath 10.118/18 as marked with a bold dashed line (C-D-E) on the attached plan.	Starts at the Parish Boundary at a pedestrian gap at Grid Reference 44484 50300 (Point C) and then follows the field edge in a north east direction for approximately 143 metres to a pedestrian gap at Grid Reference 44496 50306 (Point D) and continues in a north east and then north north east direction for approximately 243 metres to its junction with Parsons Lane County Road at a pedestrian gap at Grid Reference 44509 50326 (Point E).	2 metres

PART 3

LIMITATIONS AND CONDITIONS

<u>Position on Public Footpath 10.72/15 to which limitations and conditions apply</u>	<u>Limitations and Conditions</u>
Grid Reference 44484 50300 (Point C)	Pedestrian Gap to BS5709:2018
Grid Reference 44496 50306 (Point D)	Pedestrian Gap to BS5709:2018
Grid Reference 44509 50326 (Point E)	Pedestrian Gap to BS5709:2018

PART 4

MODIFICATION OF DEFINITIVE STATEMENT  
VARIATION OF PARTICULARS OF PATH OR WAY

Path No.	Grid Reference End Points	Description	Nature of Surface	Length (Km)	Width (m)	Lawful Obstructions and Conditions
Public Footpath 10.72/15	Not Recorded (Start)  To  Not Recorded  <b>44484 50300</b> (Finish)	Not Recorded  <b>From Grid Reference 44483 50300 proceeds in a south east direction for approximately 4 metres, to the Parish boundary at a pedestrian gap at Grid Reference 44484 50300.</b>	Not Recorded  <b>Grass</b>	Not Recorded  <b>0.004</b>  Total: Not Recorded	Not Recorded  <b>2.0</b>	Not Recorded  <b>Pedestrian Gap GR 44484 50300</b>
<b>Public Footpath 10.118/18</b>	<b>44484 50300</b> (Start)  To  <b>44509 50326</b> (Finish)	<b>Starts at the Parish Boundary at a pedestrian gap at Grid Reference 44484 50300 and then follows the field edge in a north east direction for approximately 143 metres to a pedestrian gap at Grid Reference 44496 50306 and continues in a north east and then north north east direction for approximately 243 metres to its junction with Parsons Lane County Road at a pedestrian gap at Grid Reference 44509 50326.</b>	<b>Grass</b>	<b>0.386</b>  Total: <b>0.386</b>	<b>2.0</b>	<b>Pedestrian Gap GR 44484 50300</b>  <b>Pedestrian Gap GR 44496 50306</b>  <b>Pedestrian Gap GR 44509 50326</b>

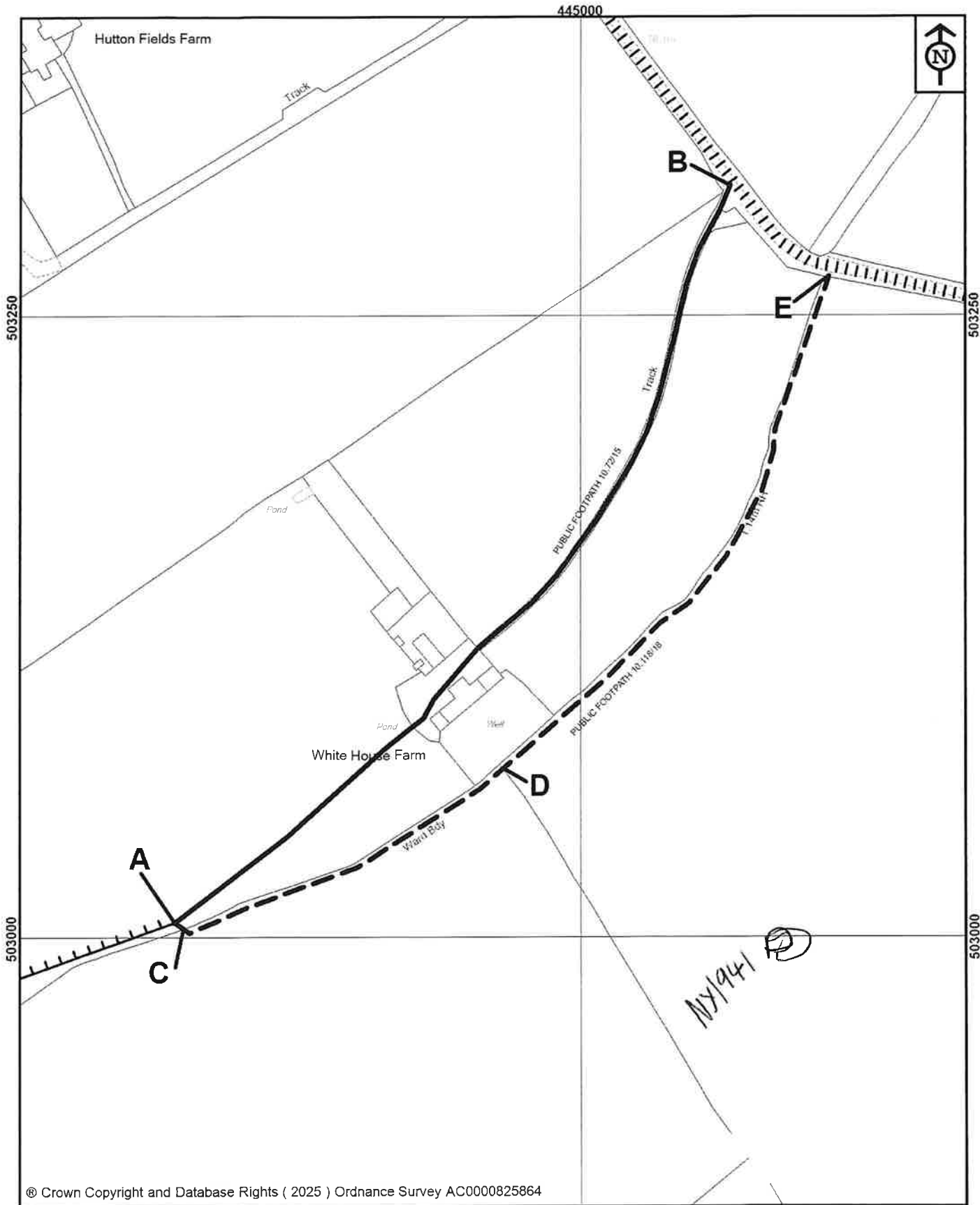

445000



**NORTH  
YORKSHIRE  
COUNCIL**

Public Rights of Way  
Countryside Access Service  
County Hall  
Northallerton  
DL7 8AH

**Key:**

- Footpath to be added
- Footpath to be deleted
- Other footpaths
- Maintainable Highways

Map drawn on 14 January 2025

Drawn by SCM

Scale 1:2000

**The North Yorkshire Council**

Highways Act 1980 Section 119  
Wildlife & Countryside Act 1981

PUBLIC FOOTPATH 10.72/15,  
WHITE HOUSE FARM, HUTTON  
RUBY DIVERSION ORDER 2025

File Ref No. HAM/2024/09/DO



