

THE NORTH YORKSHIRE COUNCIL  
(TEMPORARY PROHIBITION OF PEDESTRIANS)  
PUBLIC FOOTPATHS 10.8/3/1 APPLETON WISKE & 10.66/1/1 HORNBY  
ORDER 2024 NO 292  
Road Traffic Regulation Act 1984 – Section 14(1) (as amended)

NOTICE is hereby given that the above Order, the effect of which is to prohibit any public access along Public Footpaths 10.8/3/1 in the Parish of Appleton Wiske and 10.66/1/1 in the Parish of Hornby between grid references NZ38930467 and NZ37520456 due to an unsafe bridge has been continued in force for a further twelve months until (24<sup>th</sup> January 2026) or until the completion of the works (whichever is the earlier), under Section 15(3) of the above Act with the approval of the Secretary of State for Transport.

The further continuation of the closure will be put into effect by notices and signs.

**All enquiries to: Customer Services, Tel: 0300 131 2 131**

Further details can be viewed at:

<https://www.northyorks.gov.uk/rights-way-public-notice>

Dated: 17.01.2025

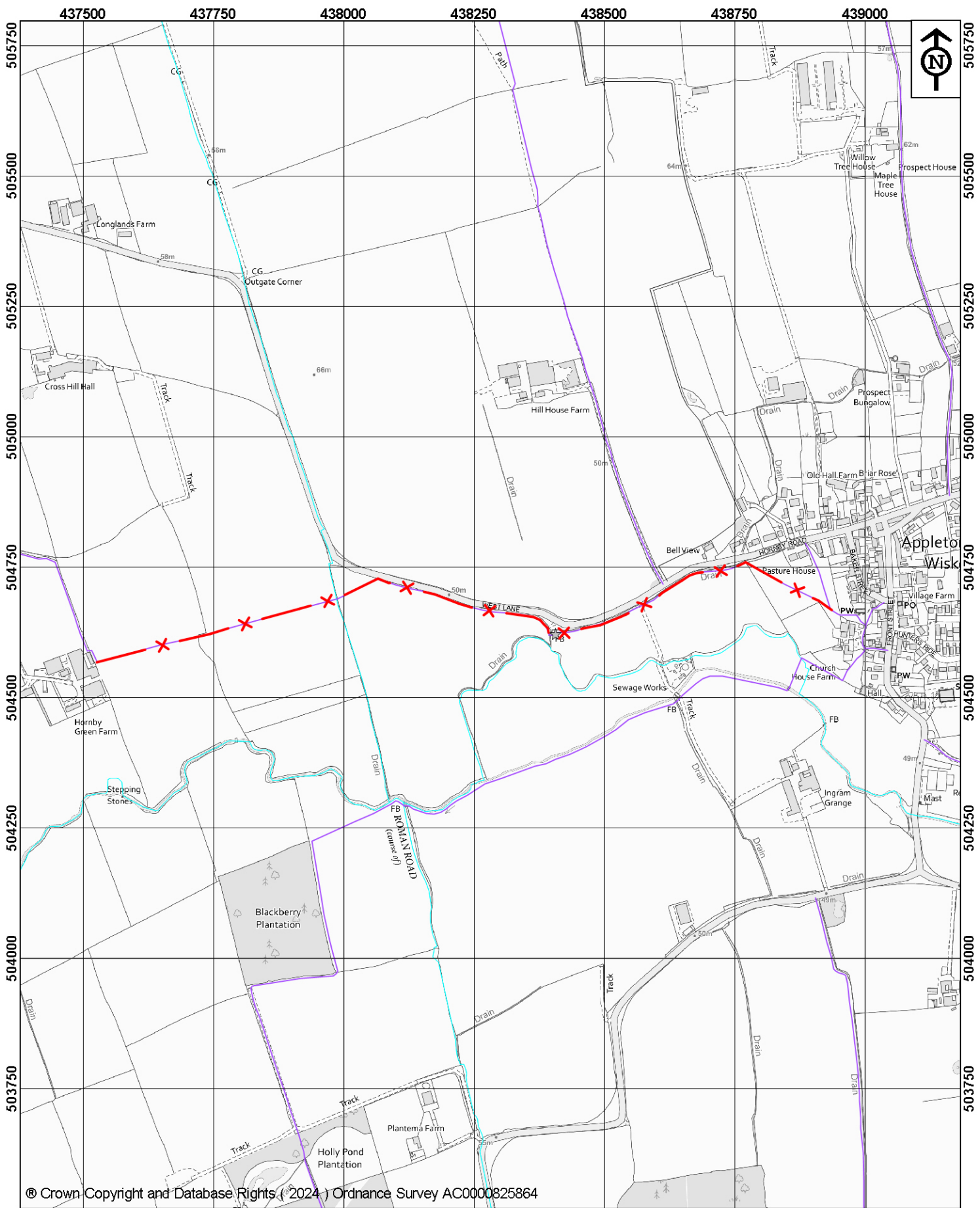

© Crown Copyright and Database Rights (2024) Ordnance Survey AC0000825864

**NORTH YORKSHIRE COUNCIL**

Public Rights of Way  
 Countryside Access Service  
 County Hall  
 Northallerton  
 DL7 8AH

Key:  
 Closed route — x — x —  
 Public Footpath — — —

Map drawn on 25 July 2024  
 Drawn by AA      Scale 1:9500

**The North Yorkshire Council**

Temporary closure of  
 Public Footpath 10.8/3/1 & 10.66/1/1  
 in Appleton Wiske and Hornby

File Ref No. 72/10/8/31/25/07/2024