

NOTES:

- 1. THIS DRAWING IS NOT TO BE USED FOR CONSTRUCTION.

KEY:

 LOADING BAY

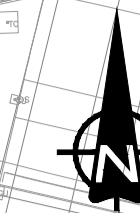

P01	31/05/2024	OS	FIRST ISSUE	EI	JP
REV	DATE	BY	DESCRIPTION	CHK	APP

DRAWING STATUS: **S2 - FOR INFORMATION**

Dale House, Mount View, Standard Way Business Park, Northallerton, DL6 2YD, UK
T+ 44 (0) TBC
wsp.com

CLIENT:
 NORTH YORKSHIRE COUNCIL

SITE/PROJECT: **HARROGATE TCF**

TITLE: **STATION PARADE NORTH
LOADING BAYS TRAFFIC REGULATION
ORDERS (TRO)**

SCALE @ A1: 1:250	CHECKED: EI	APPROVED: JB
PROJECT NO: 70089085	DESIGNED: OS	DRAWN: OS
DATE: 31/05/2024	DATE: 31/05/2024	DATE: 31/05/2024

DRAWING NO: 70089085-WSP-TCFHGTRO-DR-PW-10003	REV: P01
---	--------------------

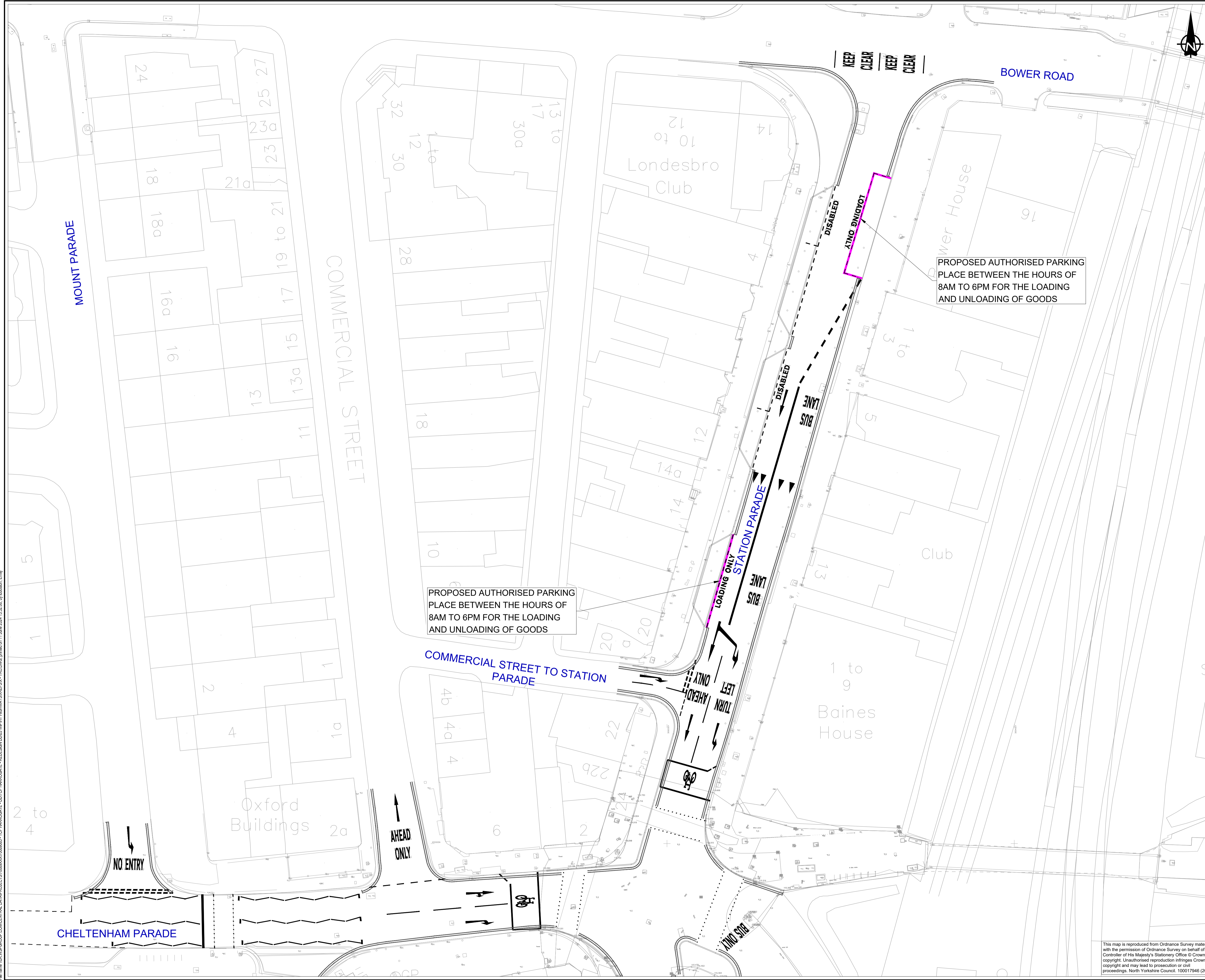

This map is reproduced from Ordnance Survey material with the permission of Ordnance Survey on behalf of the Controller of His Majesty's Stationary Office © Crown copyright and may lead to prosecution or civil proceedings. North Yorkshire Council. 100017946 (2024)

File name: U:\WSP\GROUP CENTRAL DATA\PROJECTS\70089085-TCF HARROGATE - REDIGEN\ODD WPH\PH\HIGHWAYS\REFS\X-TRO.DWG, printed on 11 June 2024 13:32:08, by Robinson, Emily